



Recommended Installation Procedure for P/N 920685 (Right Hand Thread) RotoRx Isolator Decoupler Pulley (IDP)



WARNING

- ◆ Always shut engine off before performing any work on the engine.
- ◆ Appropriate safety equipment should be worn when performing any work under the hood.
- ◆ Disconnect the battery cables from the battery terminals before removing the alternator.
- ◆ DO NOT disassemble the RotoRx IDP.

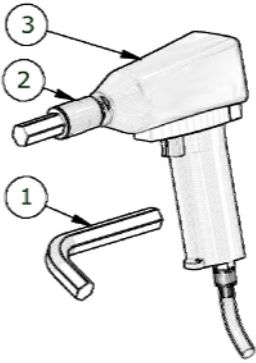

Tools Required

1. 17mm Allen Key.
2. 1/2" drive 17mm Allen Key Socket.
3. 1/2" drive Impact Gun.

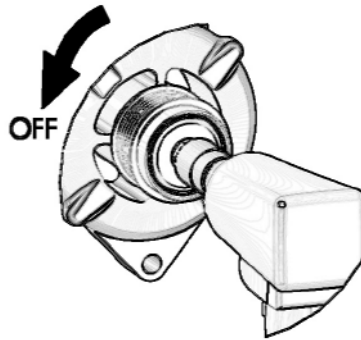

Step 1. IDP Removal:

1. Remove existing plastic cap.
2. Engage the 1/2" drive 17mm Allen Key socket and remove the old IDP with a few pulses of the impact gun. Make sure the rotation of the impact gun is counterclockwise.

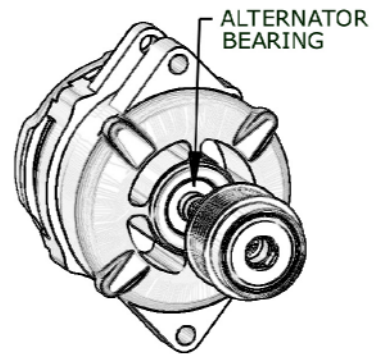

Step 2. IDP Installation:

1. Clean the alternator shaft threads of any oils/greases or debris.
2. Manually thread new IDP onto alternator shaft until it bottoms on alternator bearing, this will prevent cross-threading.

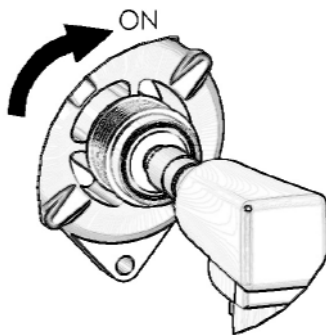

Step 3. Torquing of the IDP:

1. Engage the 1/2" Drive 17mm Allen Key socket.
 2. Support the 1/2" drive 17mm Allen Key firmly with hand.
 3. Torque the IDP with the impact gun for 3~4 seconds.
- Note: The impact gun must be set to max torque and 90 psi air supply.

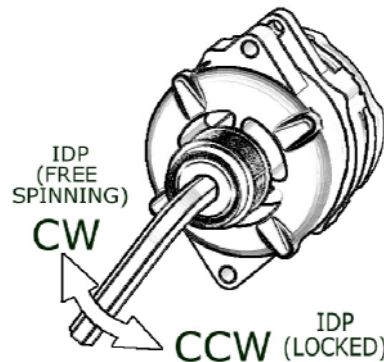

Step 4. Verification of the proper installation:

Verify the proper installation of the IDP by holding the pulley in one hand and use the 17mm Allen key to rotate the shaft. Rotate the shaft 1-2 turns clockwise. The shaft should be free and turn smoothly in the CW direction and should lock in the CCW direction.

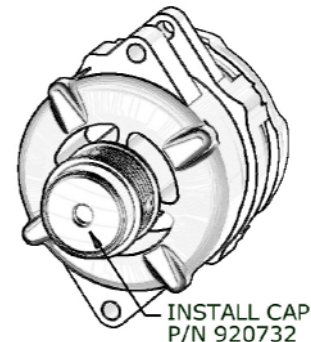

Step 5. Installation of the Cap:

1. Press the protective cap onto the front of the RotoRx IDP. Feel the entire edge of the cap to ensure proper seating.
2. A RotoRx label is provided with your new IDP. If desired, this can be applied to the plastic cap. Always ensure that the surface is clean and dry prior to application.

Step 6:

Complete the re-installation of the alternator, accessory drive belt and reconnect the battery. Remove all the tools. Start the engine for 30 seconds, shut off, and check that the belt is seated in all the pulleys and tracking properly.

Safety Reminder:

REMOVE ALL TOOLS FROM THE ENGINE AFTER THE IDP/ALTERNATOR INSTALLATION IS COMPLETED.